

PPI Piling Products, Inc.

Points & Splicers

Piling Accessories

Points and Splicers



An important accessory for long H-piles is the **Splicer**. It is a pair of U-shaped units with flared ends that slip on easily and fit tightly into the two sides of the H. A notch is cut into the web of one pile section and the splicer slipped on to the pile; it may have to be tapped on with a sledge for it is designed to fit closely. A short fillet weld is made to the flanges near the corners of the splicer. The top section of the pile must have the flanges scarfed for an efficient weld. The length of pile to be added is quickly positioned by this arrangement and held firmly. Additional weld at the opposite corners and across the flanges can be made later without delaying the driving rig and crew.

This splicer has been tested at Lehigh University (Fritz Lab) and shown to provide full strength in bending (as required by the AASHTO Bridge specifications). *

Details of Assembly

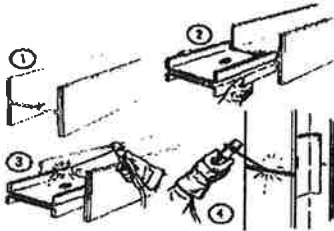

- 1) With the pile on the ground, scarf the outside edge of each flange of the H and torch cut a 7/8 in. by 2-1/2 in. notch in the web.
- 2) Force splicer on H to one-half of length. Make 5/16 x 2-1/2 in. fillet weld near each corner. (Splicer can be put on the driven length.)
- 3) Set length to be added in position. Dieformed tapers provide for quick entry and close positioning.
- 4) Make 5/16 in. (or heavier) partial penetration groove weld along the full width of each flange and a fillet weld at each remaining corner.

Piling Products, Inc.

945 Center Street * Green Cove Springs * Florida * 32043

Certified DBE/WBE

(904) 287-8000 Fax (904) 529-7757

ppisteel@bellsouth.net www.pilingproducts.com